

Technical Specification



Frequency Range(GHz)	8.2 – 12.4
Waveguide	WR90
Polarization	Linear
Focal Length(mm)	350 Typ.
Spot Size(mm)	Φ90 Typ.
VSWR	A Type: 1.60:1 Max.
	C Type: 1.80:1 Max.
Output	A Type: FBP100(UBR100)
	C Type: SMA-Female or N-Female or TNC-Female or 7mm or 3.5mm-Female
Material	Al
Size(mm)	A Type: 249 x 249 x 378.6
	C Type: 249 x 249 x 416.6
Net Weight(Kg)	A Type: 5.50 Around
	C Type: 5.56 Around

Outline Drawing (Size: mm)

FBP100 Output (P/N: LB-CLS-90-70-50-A)

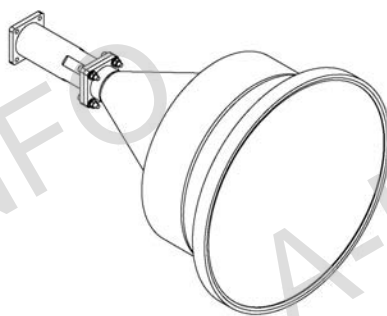
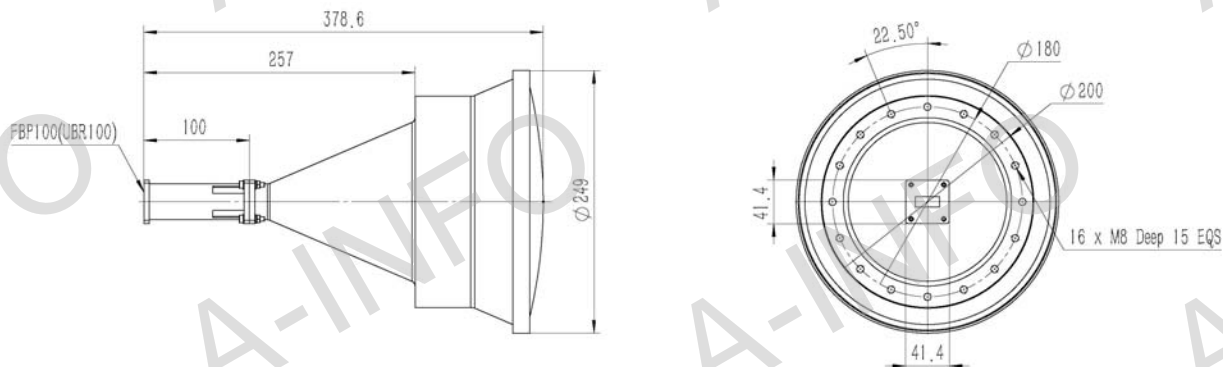

AINFO Inc.

Page 1 of 6

China(Beijing):
China(Chengdu):
USA :

Tel: (+86) 10-6266-7326,
Tel: (+86) 28-8519-2786,
Tel: (+1) 949-639-9688,

(+86) 10-6266-7327
(+86) 28-8519-3044
(+1) 949-639-9608

Fax: (+86) 10-6266-7379
Fax: (+86) 28-8519-3068
Fax: (+1) 949-639-9670

Website: www.ainfoinc.com
Email: sales@ainfoinc.com

SMA-Female Output (P/N: LB-CLS-90-70-50-C-SF)

For N-Female, TNC- Female, 7mm or 3.5mm-Female output outline drawing, please contact A-INFO.

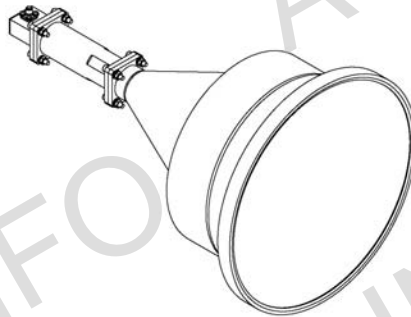
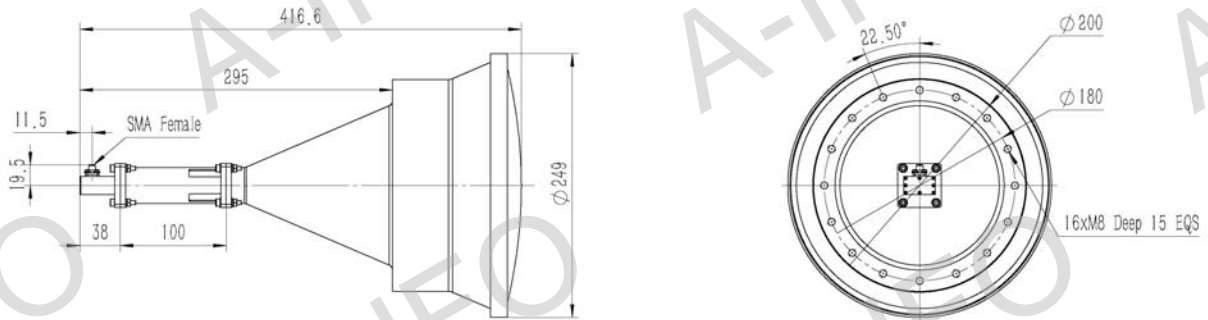

SMA-Female Output with Round Mounting Bracket (Option, P/N: LB-CL-90-70-MB)

For N-Female, TNC- Female, 7mm or 3.5mm-Female output outline drawing, please contact A-INFO.

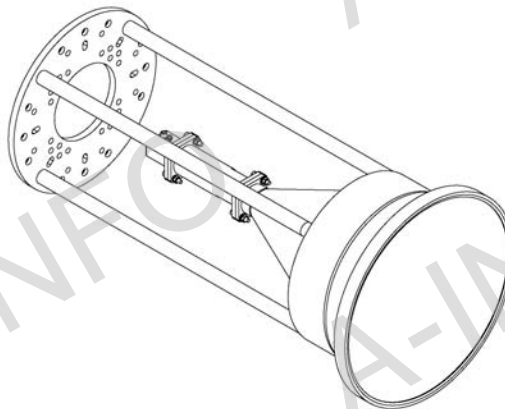
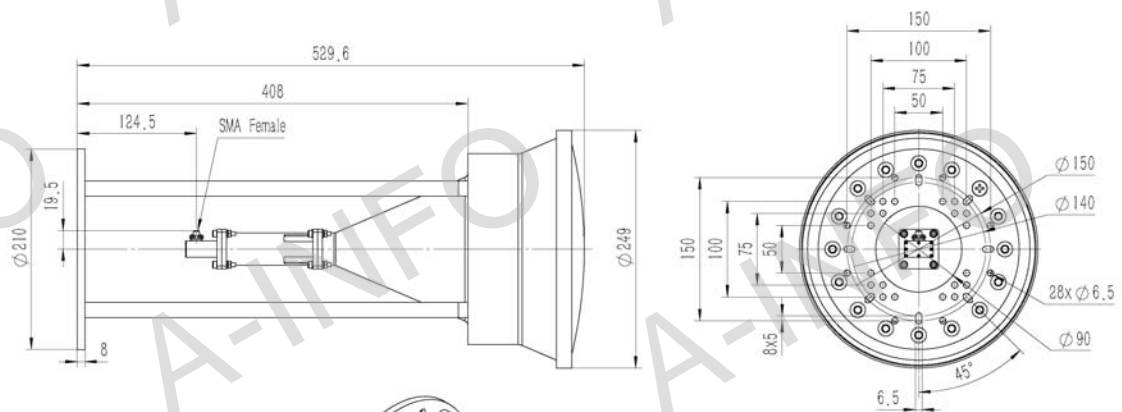

SMA-Female Output with L Type Mounting Bracket (Option, P/N: LB-CL-90-70-L)

For N-Female, TNC- Female, 7mm or 3.5mm-Female output outline drawing, please contact A-INFO.

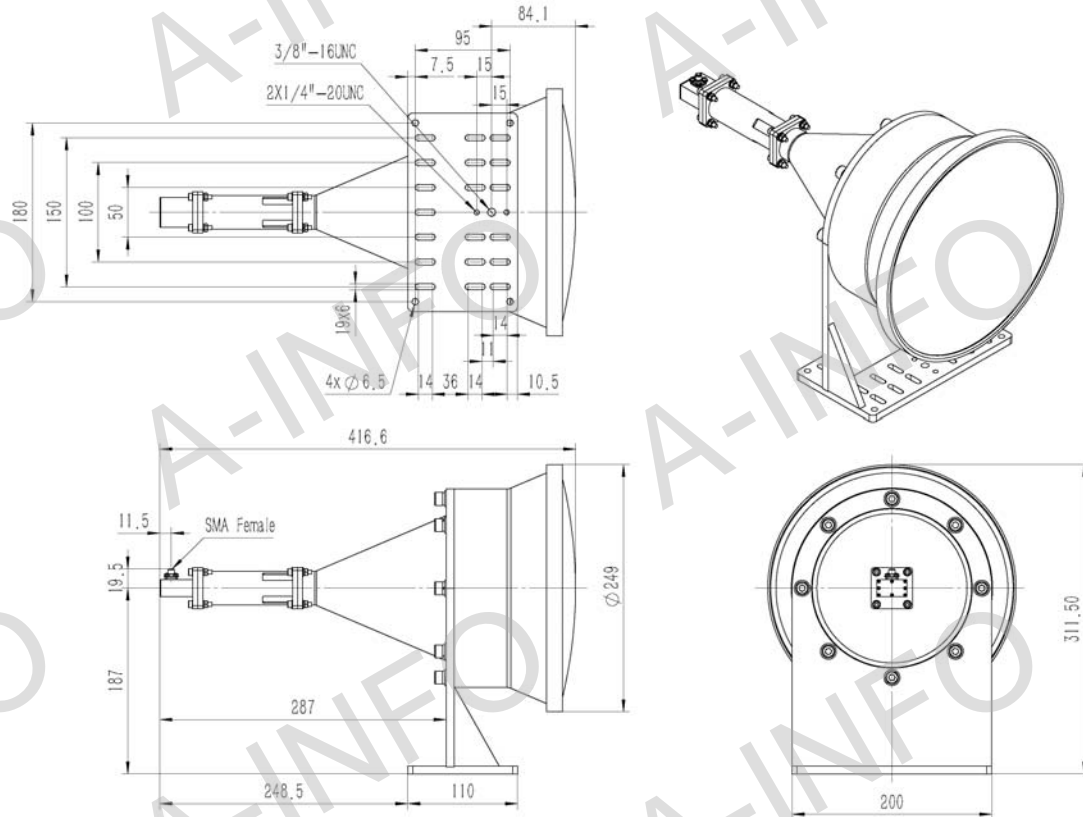

Flange Drawing (Size: mm)

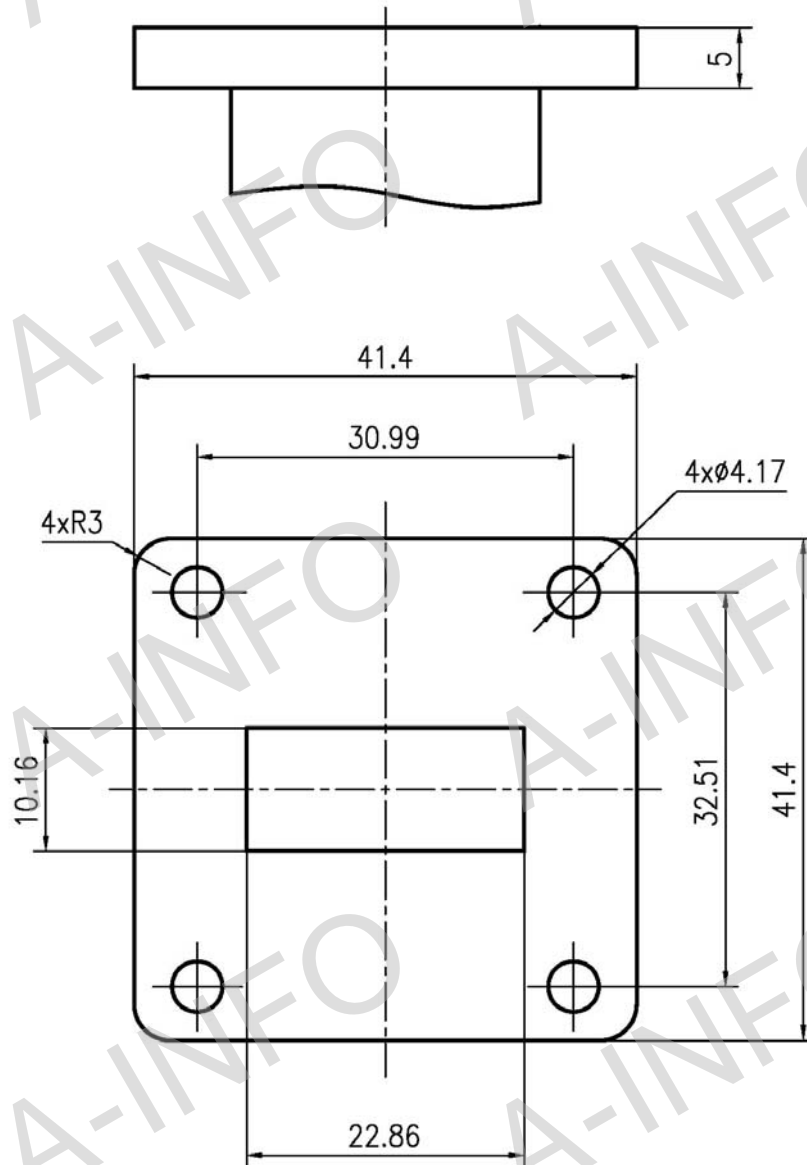

FBP100

AINFO Inc.

Page 4 of 6

China(Beijing):
China(Chengdu):
USA :

Tel: (+86) 10-6266-7326,
Tel: (+86) 28-8519-2786,
Tel: (+1) 949-639-9688,

(+86) 10-6266-7327
(+86) 28-8519-3044
(+1) 949-639-9608

Fax: (+86) 10-6266-7379
Fax: (+86) 28-8519-3068
Fax: (+1) 949-639-9670

Website: www.ainfoinc.com
Email: sales@ainfoinc.com

Test Results

1. Spot Size

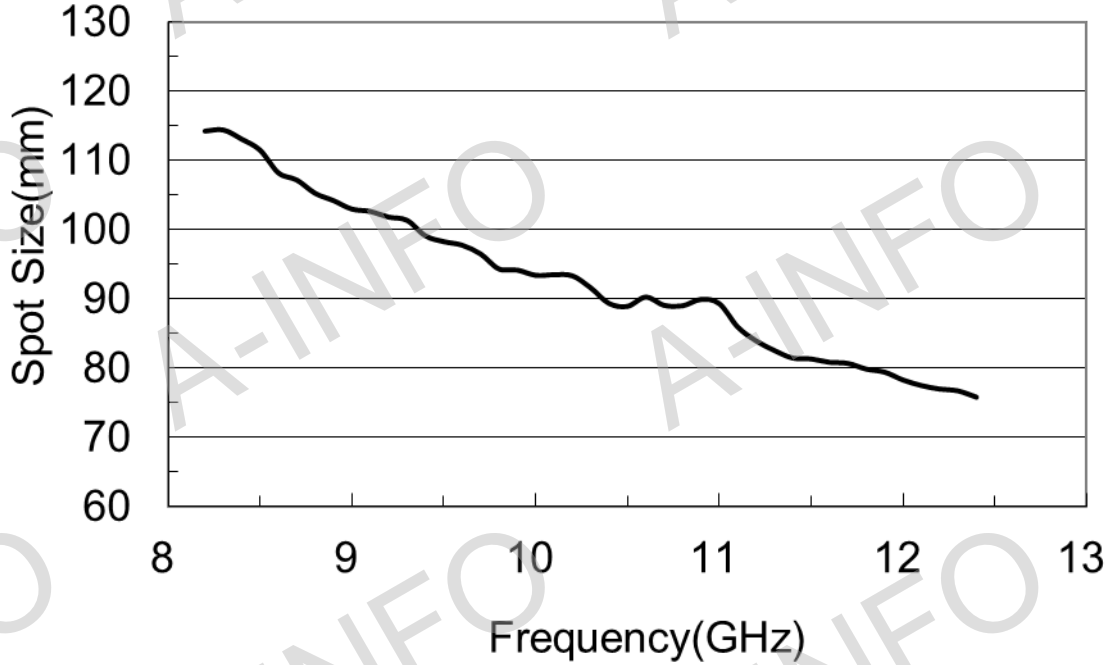

2. VSWR_A Type

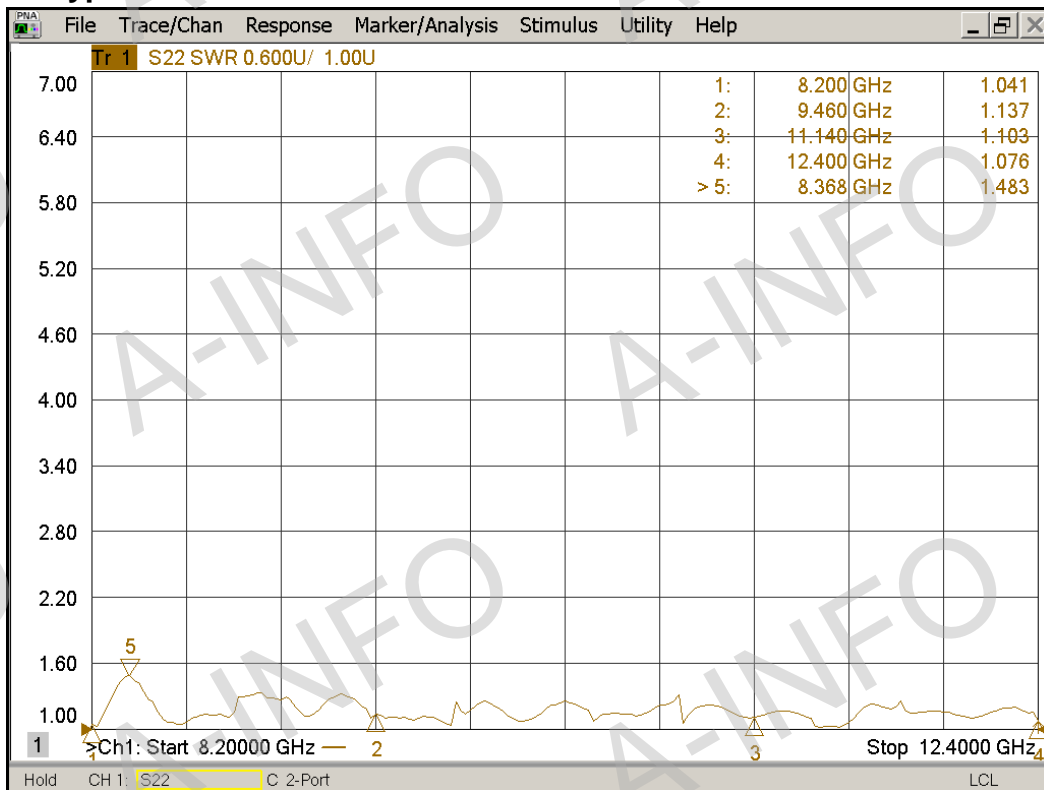

VSWR_C Type

