

Technical Specification

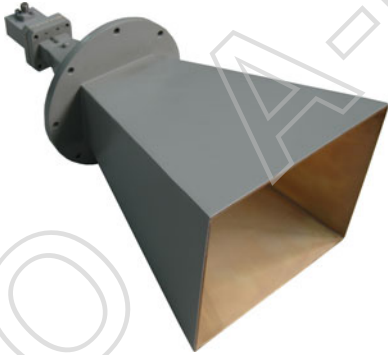

| | |
|----------------------------------|---------------------------------|
| Frequency Range (GHz) | 5.8 - 16.0 |
| Gain(dB) | 20 Typ. |
| Polarization | Linear |
| VSWR | 2.0 Max |
| Cross Polarization Isolation(dB) | -30 Typ. |
| Waveguide(A Type) | WRD580D28 |
| Adapter(C Type) | 580DRWCAS or 580DRWCAN |
| Connector(C Type) | SMA-F or N-F |
| Size(mm) | 134x112x286 (Including Adapter) |
| Net Weight(Kg) | 0.7 Around (Including Adapter) |

Outline Drawing (Size: mm) Including Adapter

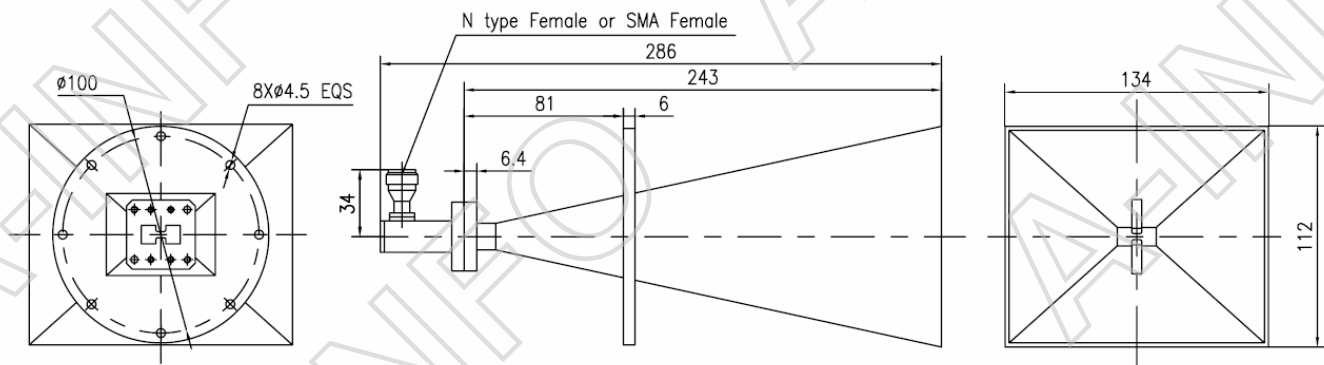

Flange Drawing (Size: mm)

FPWRD580D28

(With two through mounting holes and two screws holes)

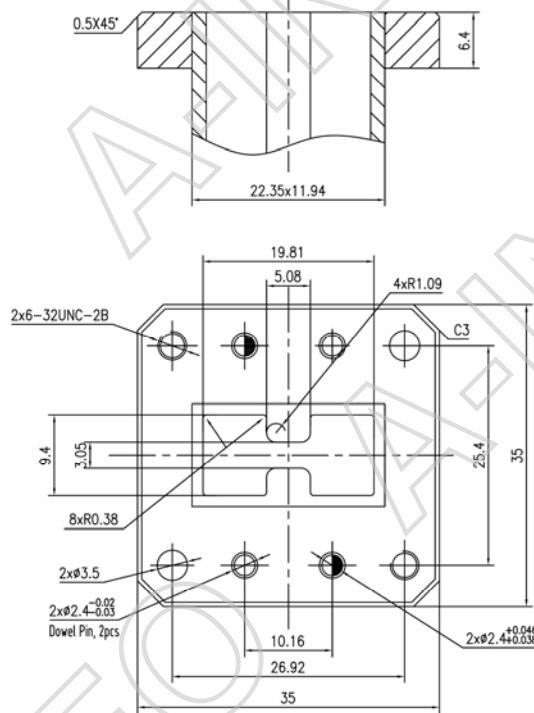

Test Results

1. Gain

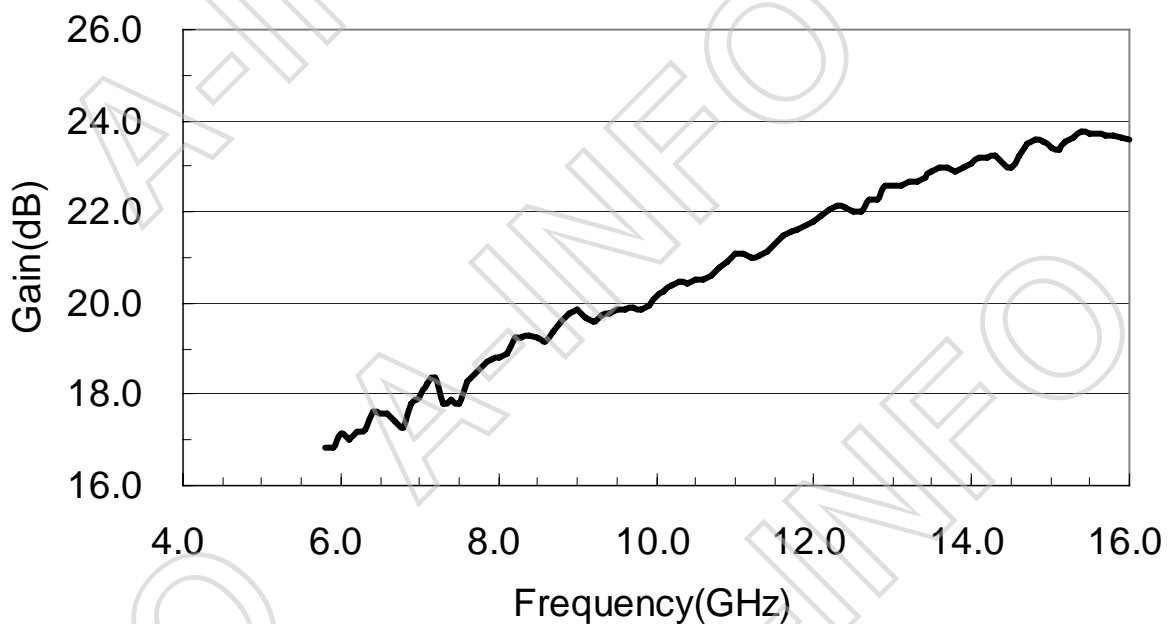

2. Antenna Factor

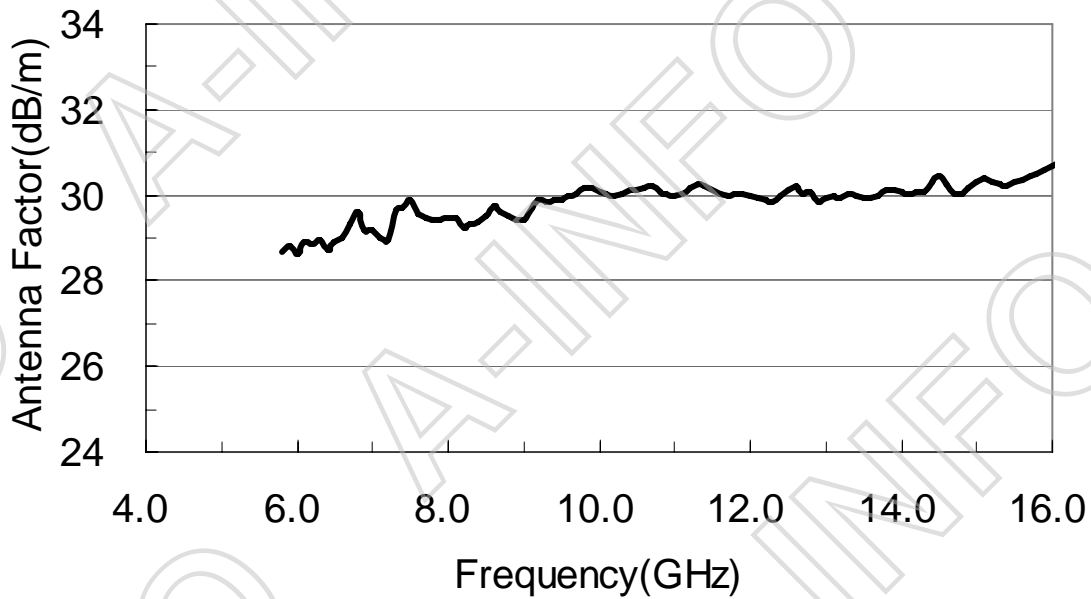

3. VSWR

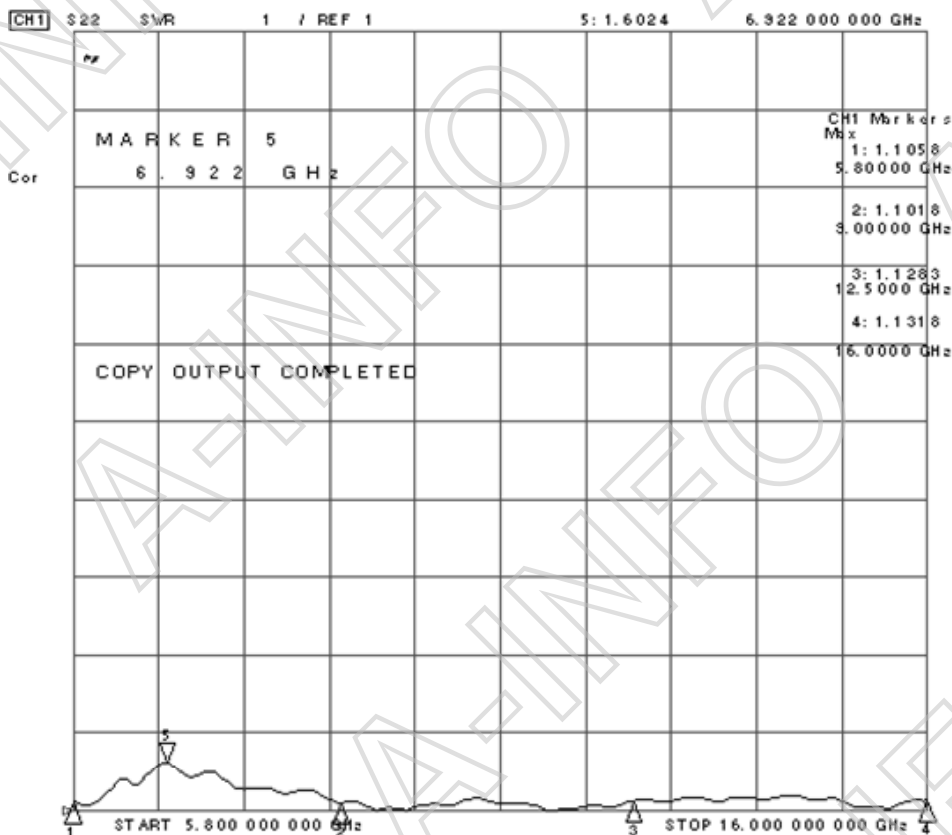

4. Cross Polarization Isolation

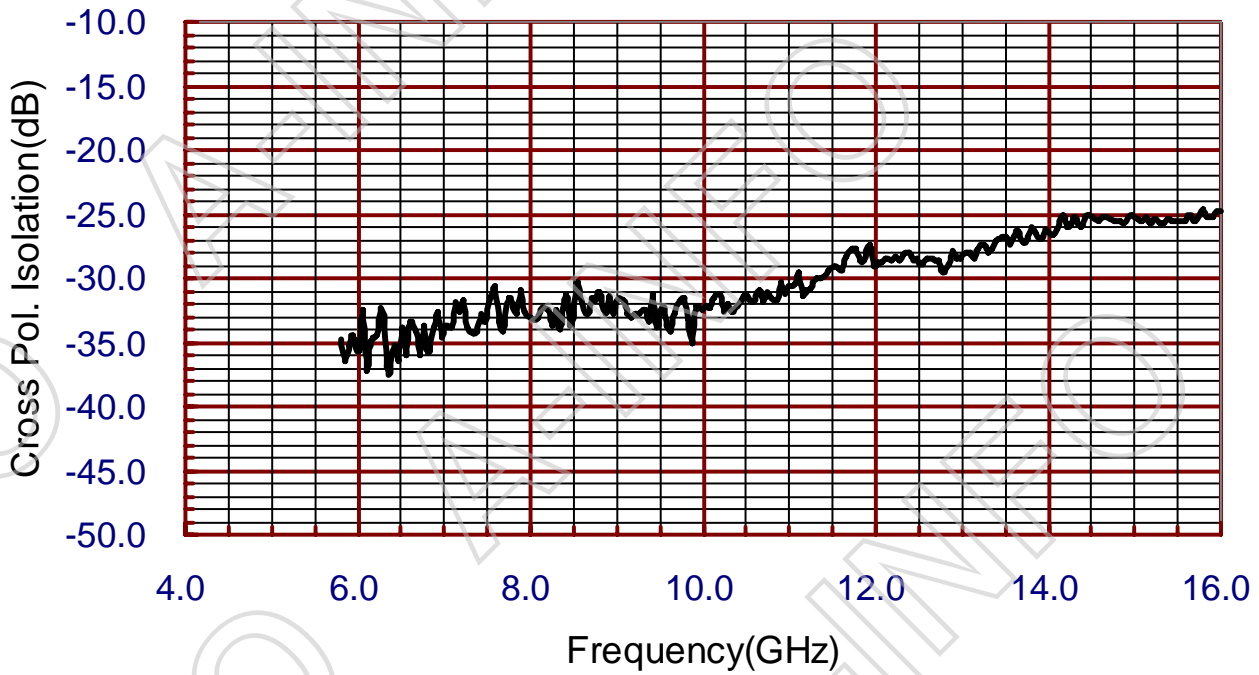

5. Pattern

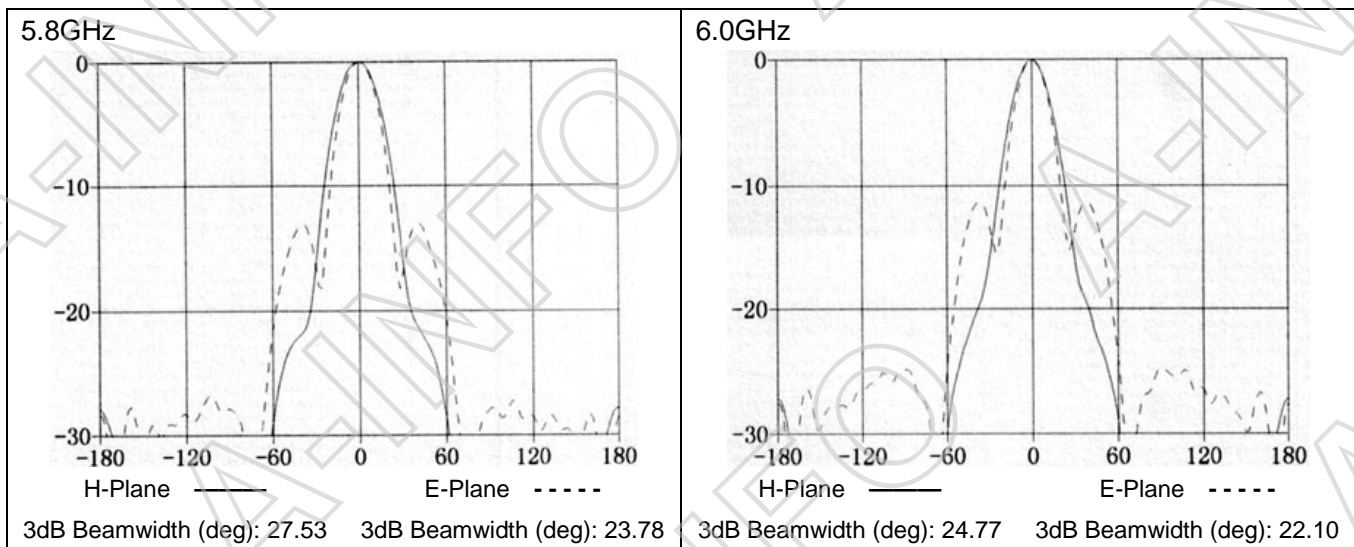

6.5GHz

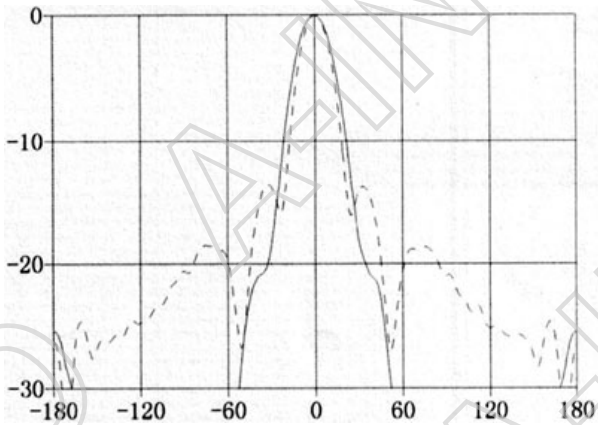

H-Plane ——— E-Plane - - - - -
3dB Beamwidth (deg): 23.81 3dB Beamwidth (deg): 20.24

7.0GHz

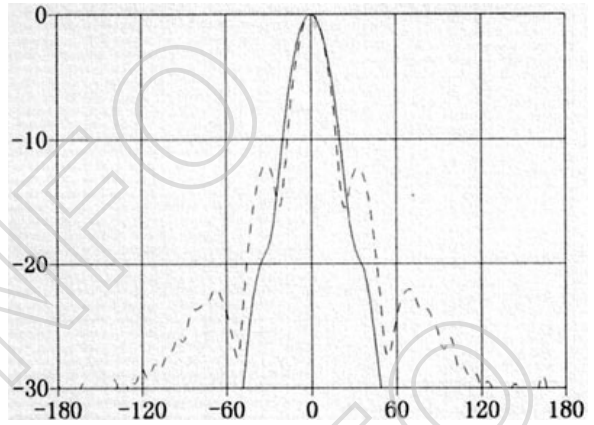

H-Plane ——— E-Plane - - - - -
3dB Beamwidth (deg): 21.96 3dB Beamwidth (deg): 19.65

7.5GHz

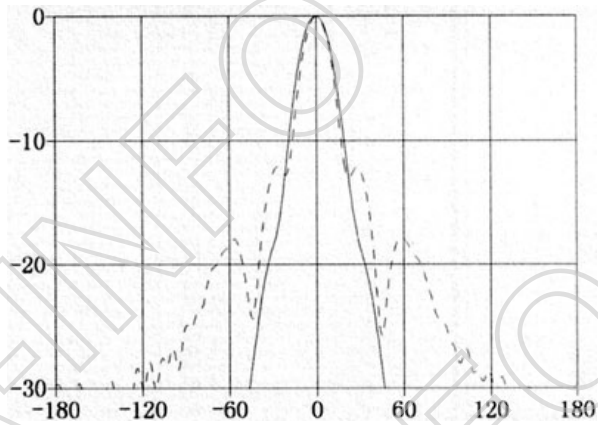

H-Plane ——— E-Plane - - - - -
3dB Beamwidth (deg): 21.03 3dB Beamwidth (deg): 18.40

8.0GHz

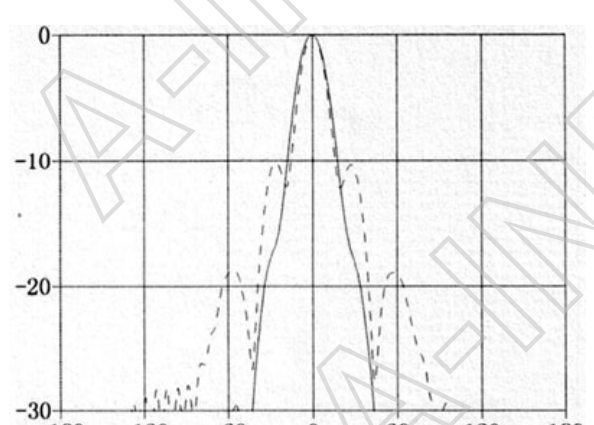

H-Plane ——— E-Plane - - - - -
3dB Beamwidth (deg): 19.59 3dB Beamwidth (deg): 17.10

8.5GHz

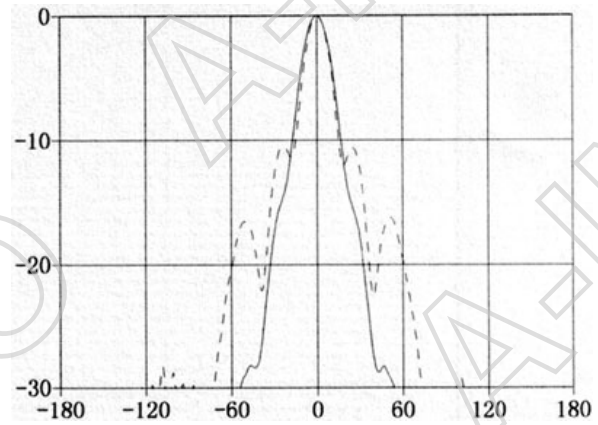

H-Plane ——— E-Plane - - - - -
3dB Beamwidth (deg): 18.40 3dB Beamwidth (deg): 16.39

9.0GHz

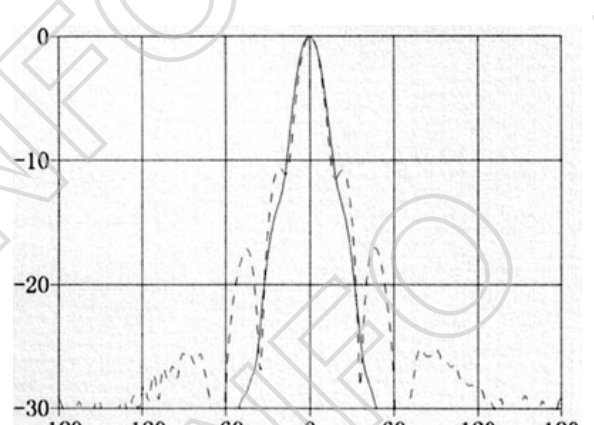

H-Plane ——— E-Plane - - - - -
3dB Beamwidth (deg): 17.64 3dB Beamwidth (deg): 15.84

